



CHRIS FASONE SUPERINTENDENT

Chris Fasone has successfully helped to deliver multiple types of facilities including higher education, commercial, healthcare and K-12 education. He has acquired an extensive background in all aspects of building construction and is dedicated to the highest level of quality on every project that he is involved in.

Chris is an employee-owner of Bartlett Cocke General Contractors.

RELEVANT EXPERIENCE



Texas A&M University, Center for Infrastructure Renewal (CIR); \$64,568,378; 138,891 SF; Bryan, TX

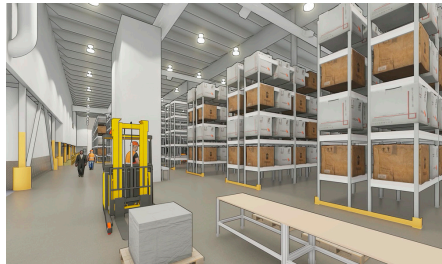

FujiFilm Nexus Warehouse; \$22,865,409; 91,254 SF; College Station, TX



University Health System, Robert B. Green Campus; \$108,244,845; 300,000 SF; San Antonio, TX



Lone Star College, East Aldine Satellite Center; \$36,355,398; 109,743 SF; Houston, TX

BARTLETT COCKE GENERAL CONTRACTORS

13 years with BCGC
24 years industry experience

ROLE & RESPONSIBILITY

Serving as Superintendent, Chris will be responsible for:

- overseeing all field operations
- assuring safety and quality compliance
- adhering to the project schedule
- coordinating all subcontractor activities
- coordinating and facilitating all weekly project coordination meetings
- maintaining as-built documents
- managing the warranty program

EDUCATION

*Texas A&M University
Kingsville
Bachelor of Arts,
Mathematics & Physics*

CITY OF RESIDENCE

San Antonio, TX

BUILDING BETTER LIVES

TRAINING & CERTIFICATIONS

- OSHA 30 HR
- CPR/First Aid/AED

REFERENCES

Texas A&M University
Randy Wipke
979.458.7071

Energy Architecture
Todd Arenz
713.487.3400